

FLARE See Through 50H Outdoor

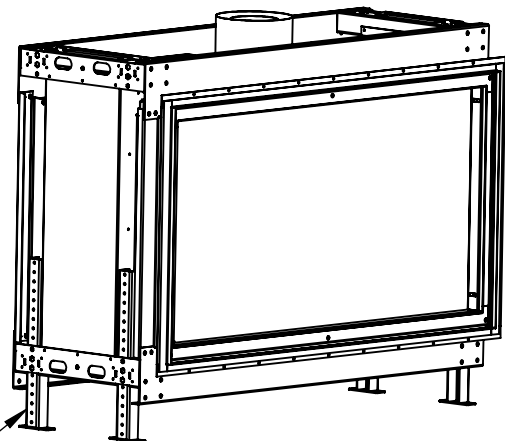
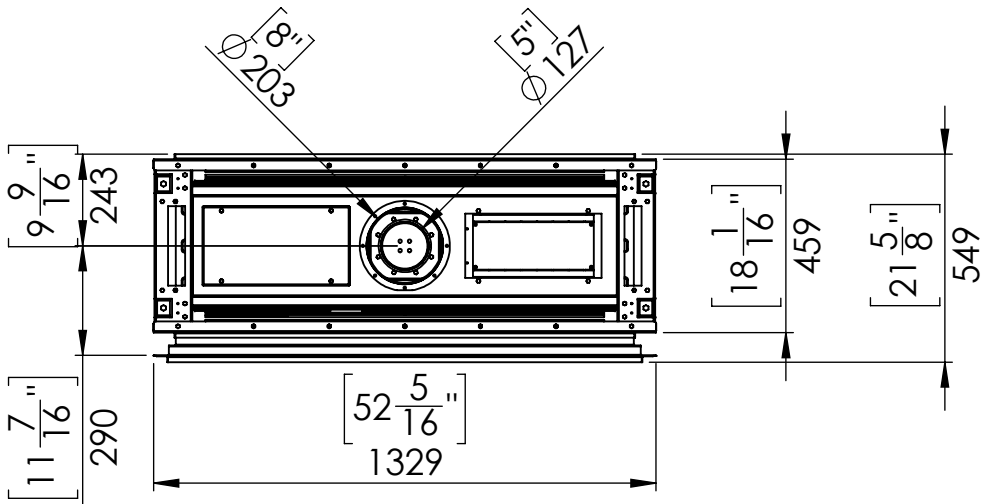
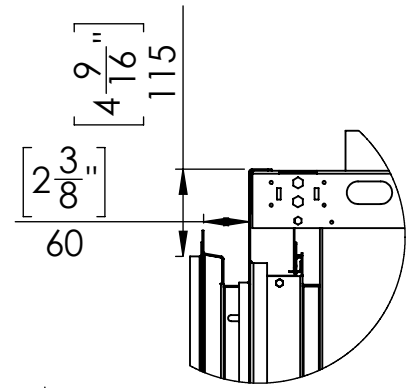
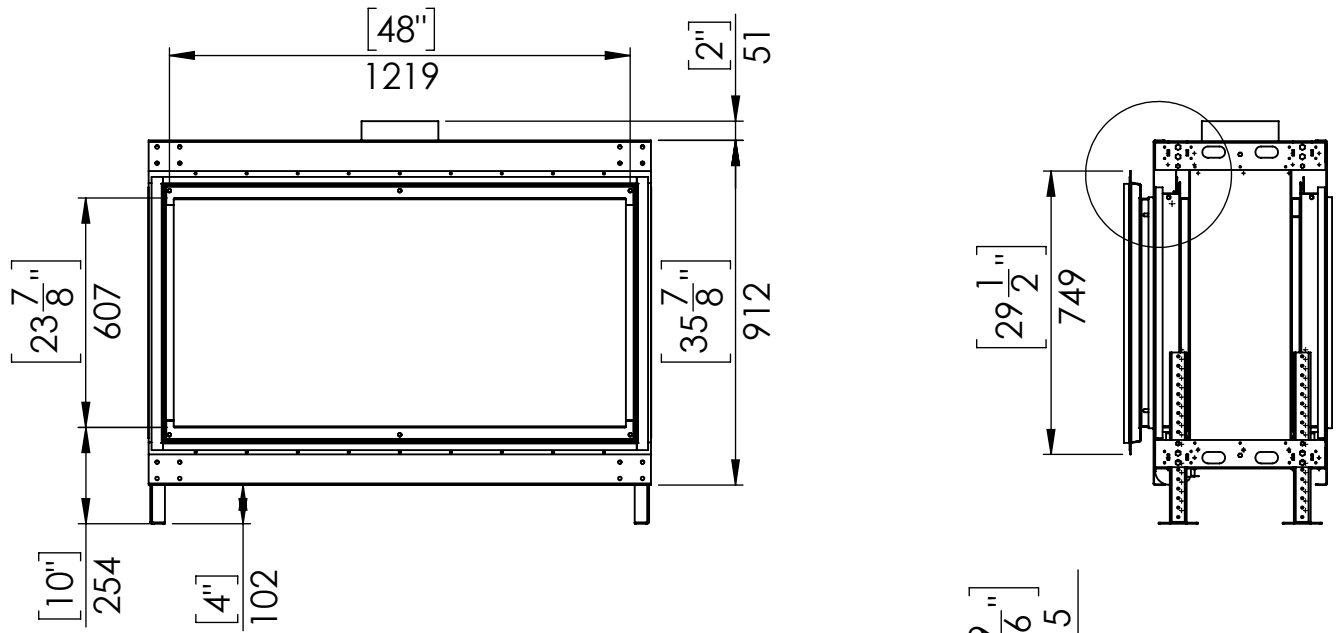

Telescopic legs ranges (from bottom of glass): 10"-19"

Flat installtion - option 1

Metal studs **surrounding all sides** of Fireplace

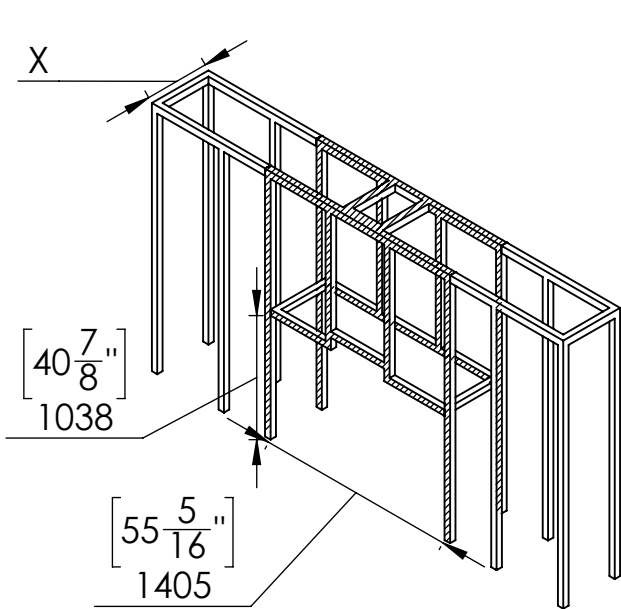

▨ Metal stud

Recess installtion - option 1

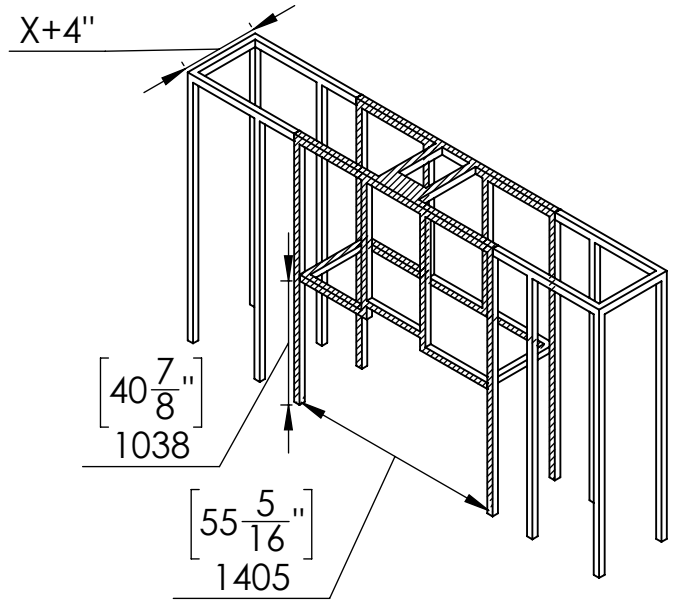

▨ Metal stud

Flat installtion - option 2

Metal studs **above** the Fireplace **only**

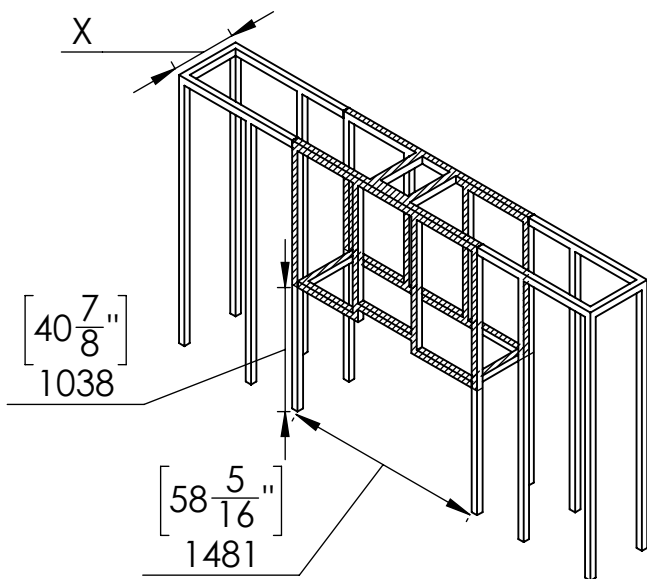

▨ Metal stud
□ Coverd Wood stud

Recess installtion - option 2

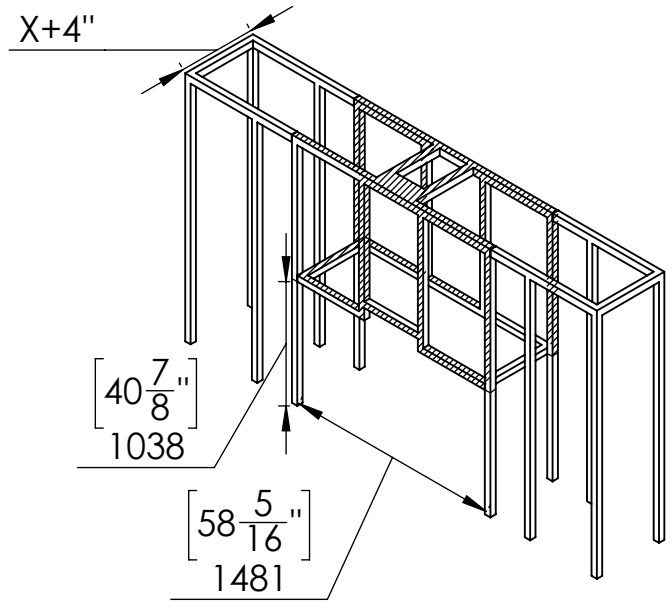

▨ Metal stud
□ Coverd Wood stud

External Cement Board Opening

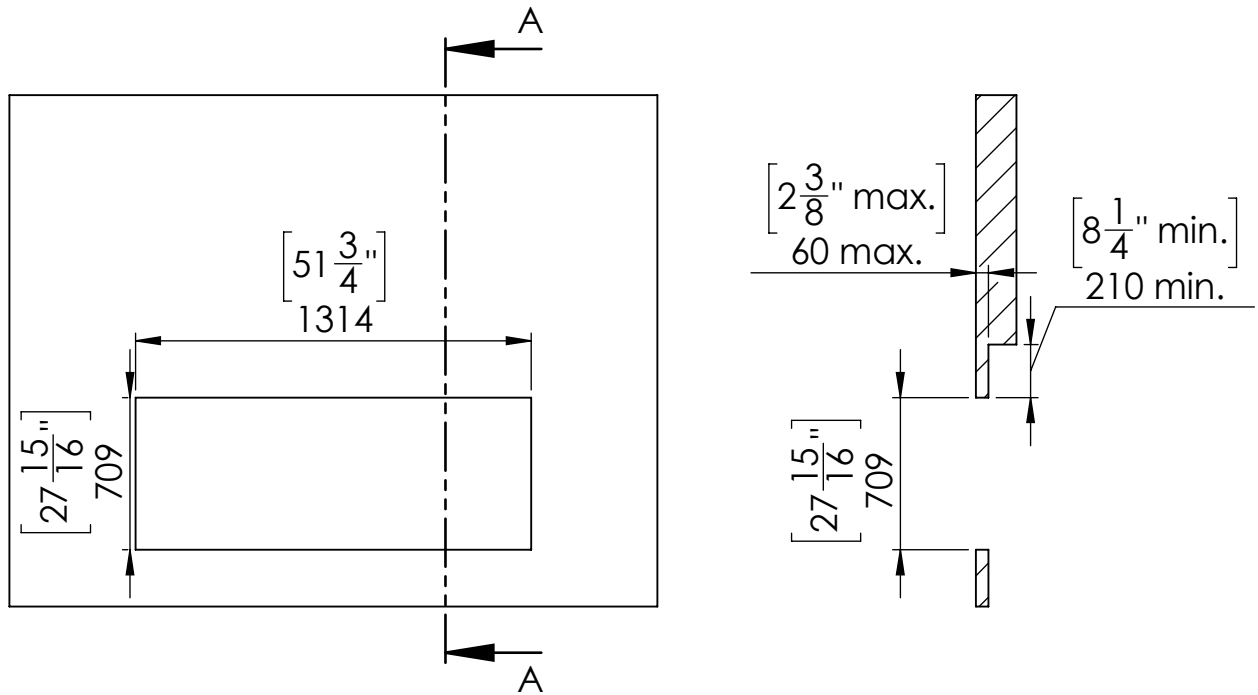

Outdoor Kit - External Frame

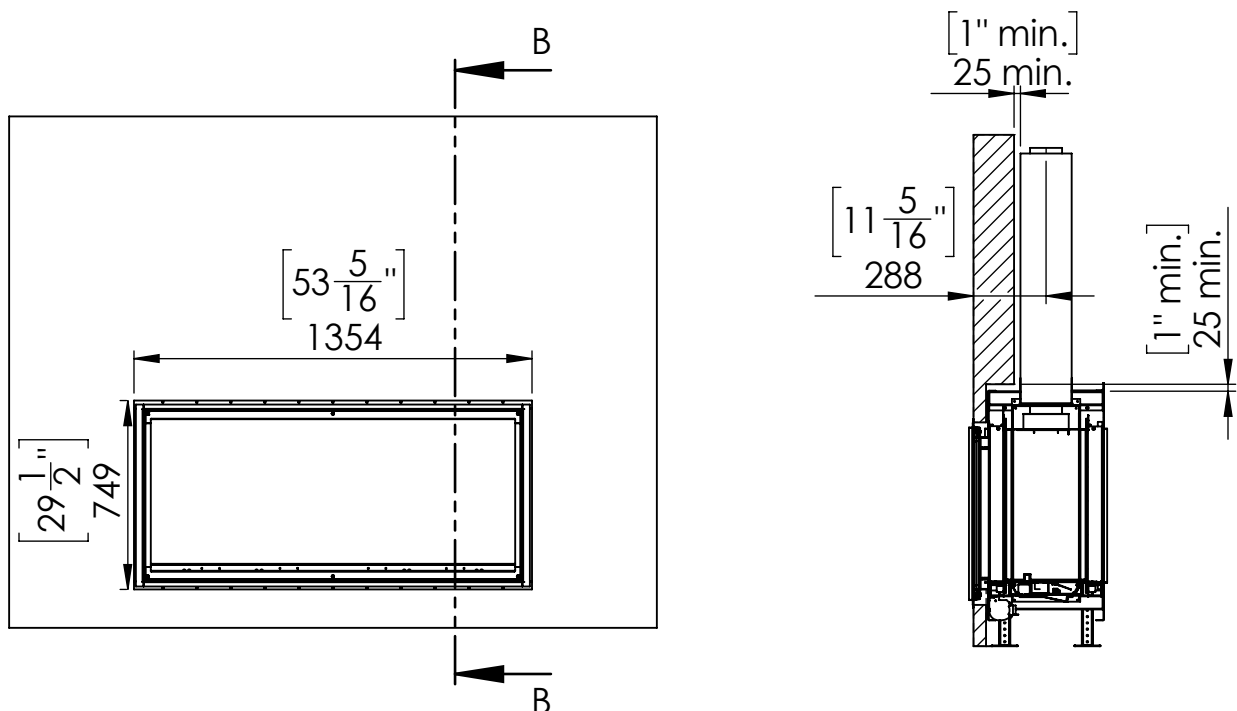

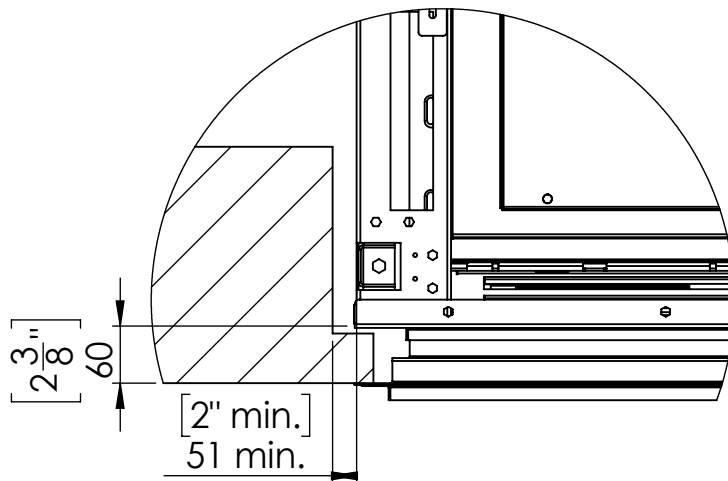
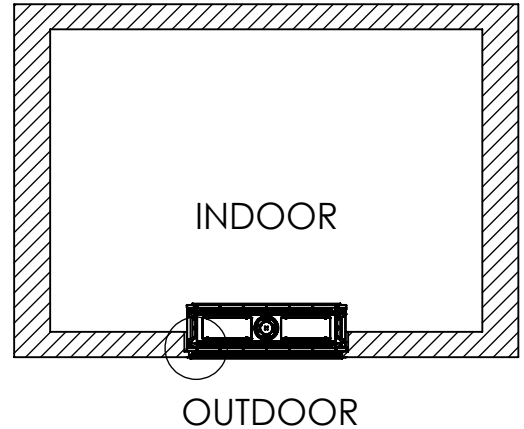
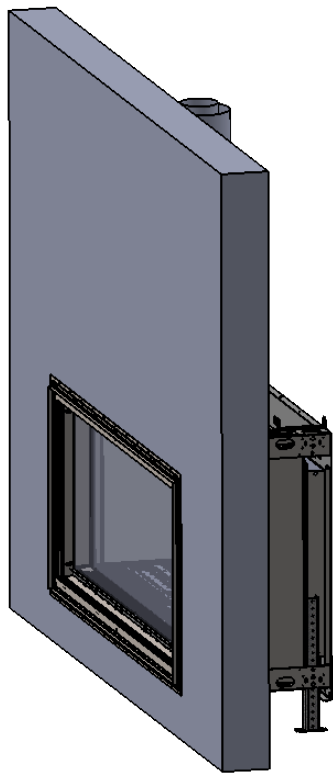

Specifications for Appliance Flare See Through 50

Factor	NG	LPG
Burner Type	105	105
Orifice	1200	320
BTU Max.	47000	35100
BTU min.	22750	18500
Kw/h	13.8k	10.2k
Chimney DIA.	5X8	5X8
Manifold Pressure[w.c]	4.9	10.4
Efficiency rate	78	82
Glass Size Length\Width	1270.5 X 620 mm	50" X 24" 7/16'
Appliance Weigh	155Kg	341lb