

Flat installtion - option 1

Metal studs **surrounding all sides** of Fireplace

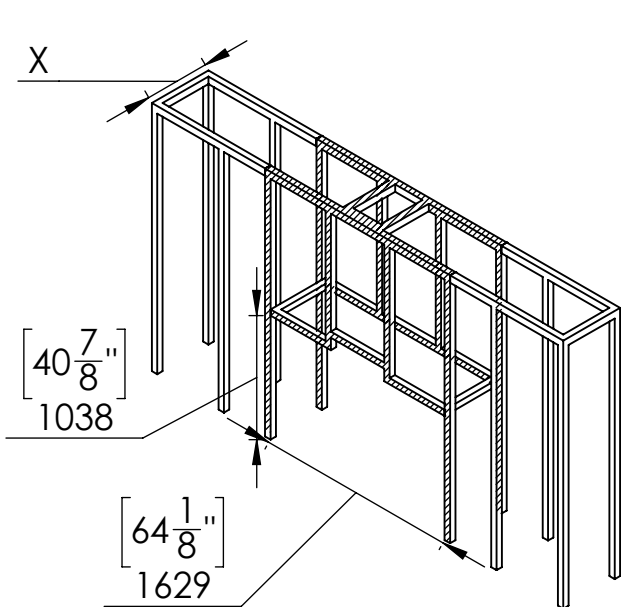

▨ Metal stud

Recess installtion - option 1

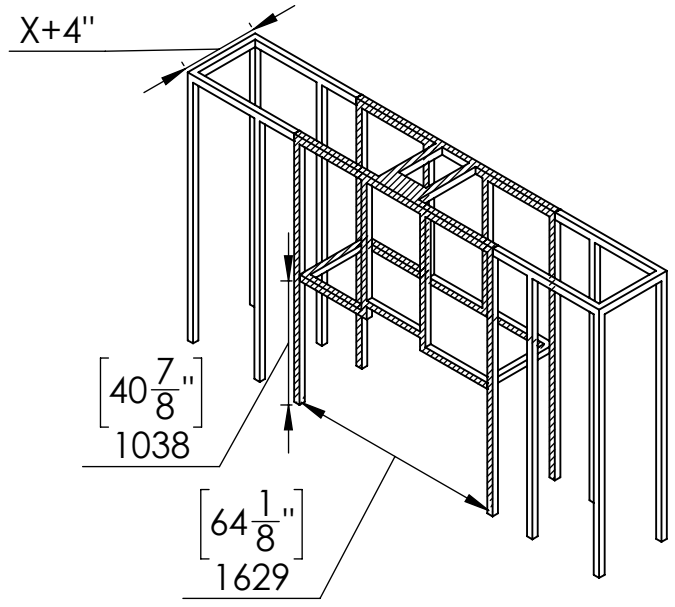

▨ Metal stud

Flat installtion - option 2

Metal studs **above** the Fireplace **only**

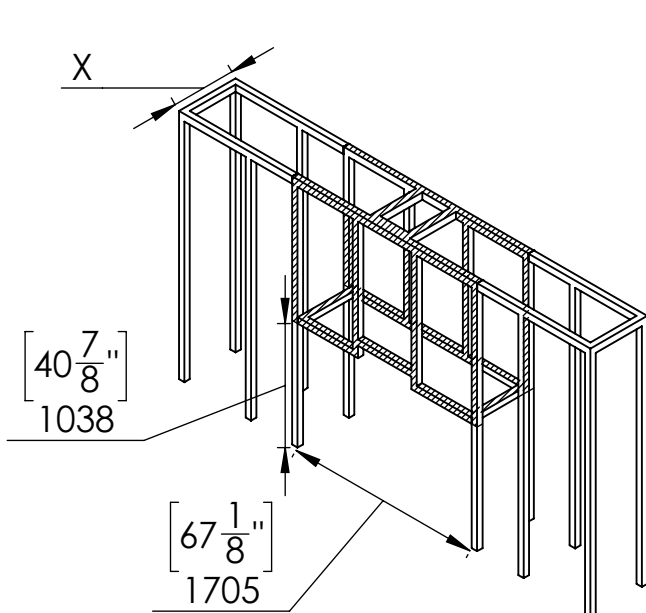

▨ Metal stud
□ Coverd Wood stud

Recess installtion - option 2

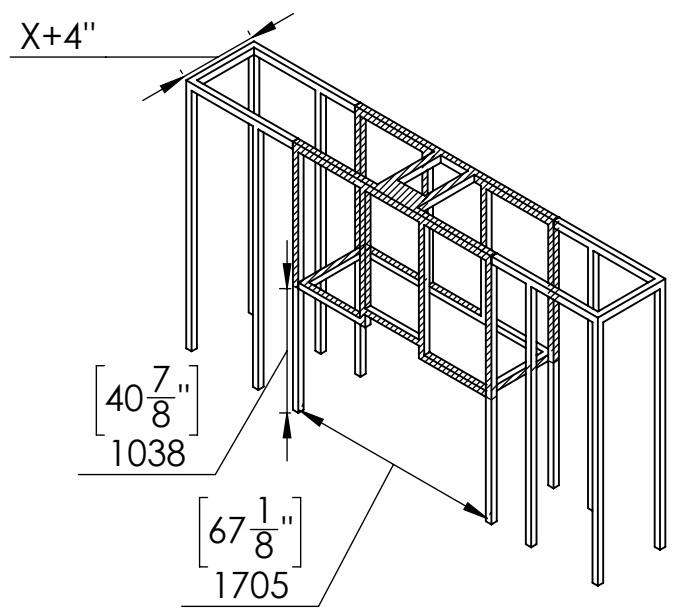

▨ Metal stud
□ Coverd Wood stud

External Cement Board Opening

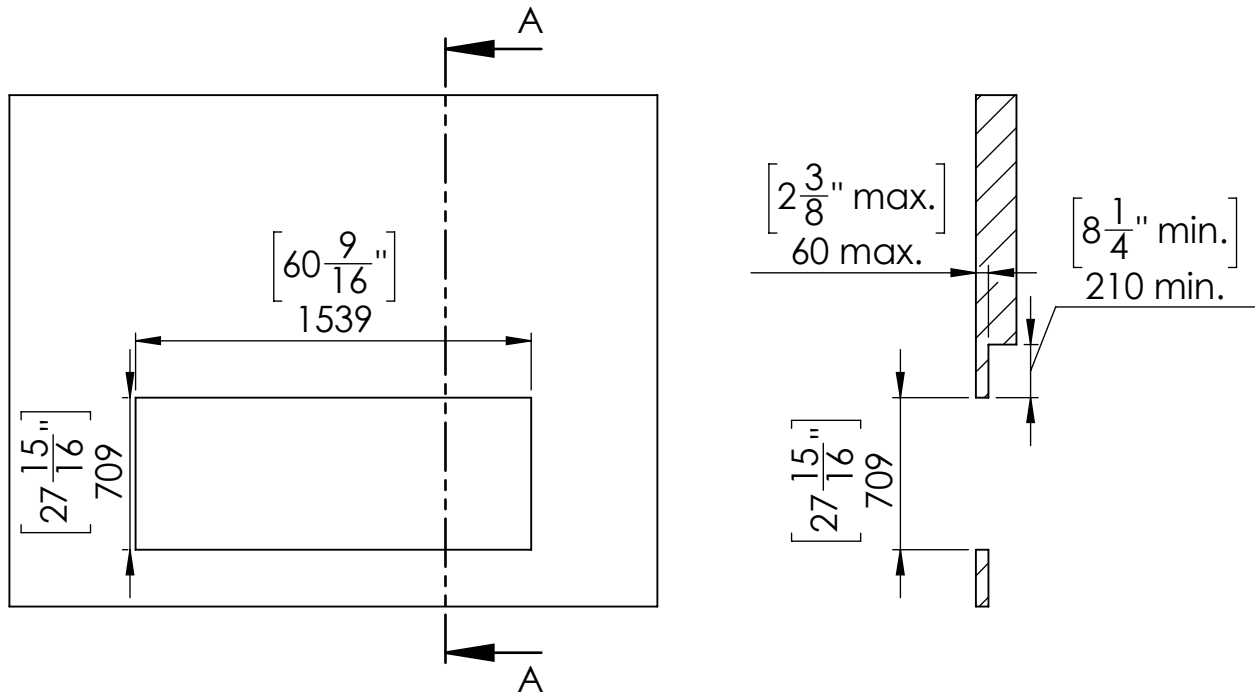

Outdoor Kit - External Frame

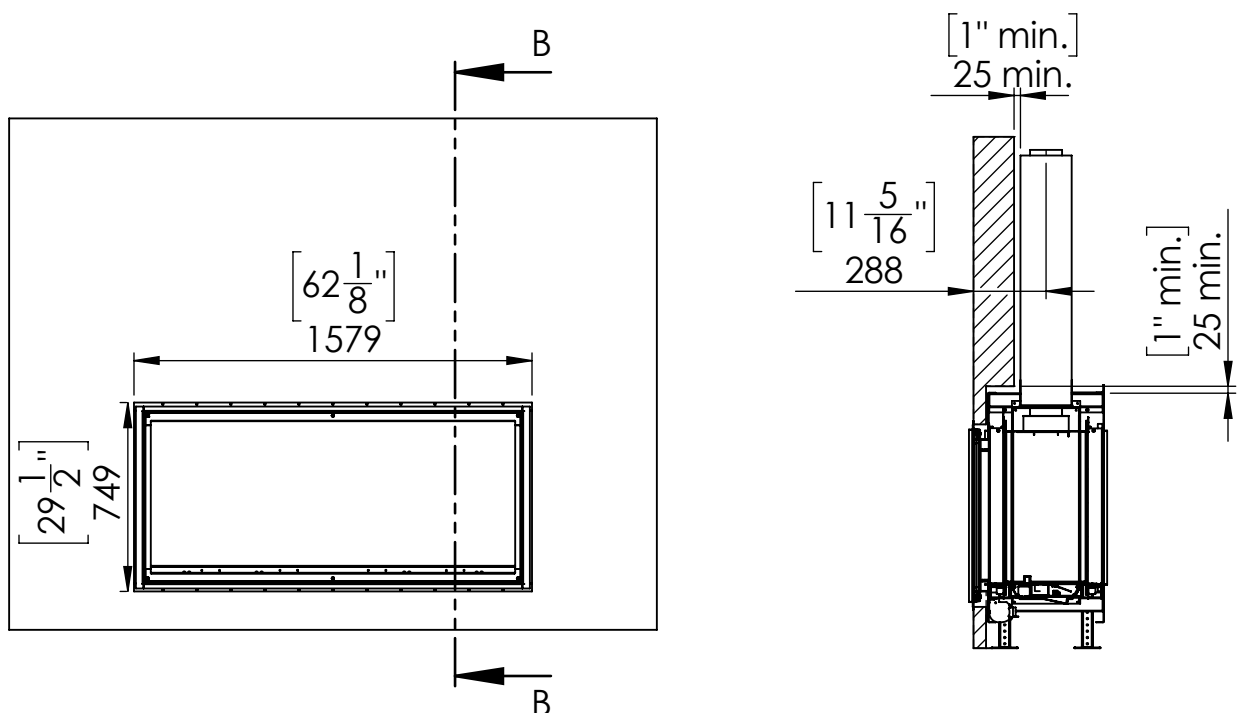

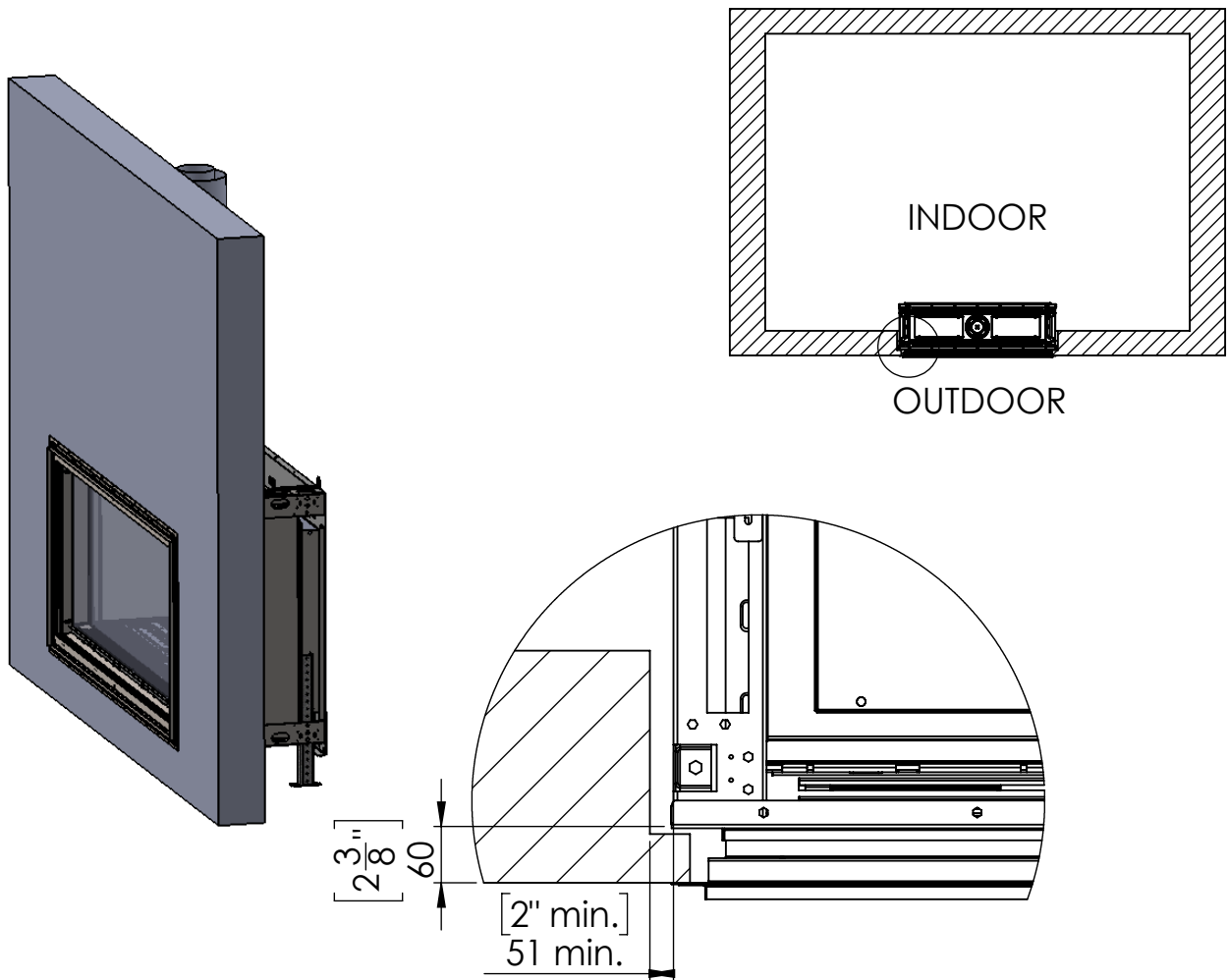

Specifications for Appliance Flare See Through 60

Factor	NG	LPG
Burner Type	35,55,35	35,55,35
Orifice	500,800,500	160,160,160
BTU Max.	50000	41000
BTU min.	28000	20000
Kw/h	14.6k	12k
Chimney DIA.	5X8	5X8
Manifold Pressure[w.c]	3.3	10.4
Efficiency rate	77	80
Glass Size Length\Width	1520.5 X 620 mm	59" 7/8' X 24" 7/16'
Appliance Weigh	180Kg	396lb