

FLARE See Through 70H Outdoor

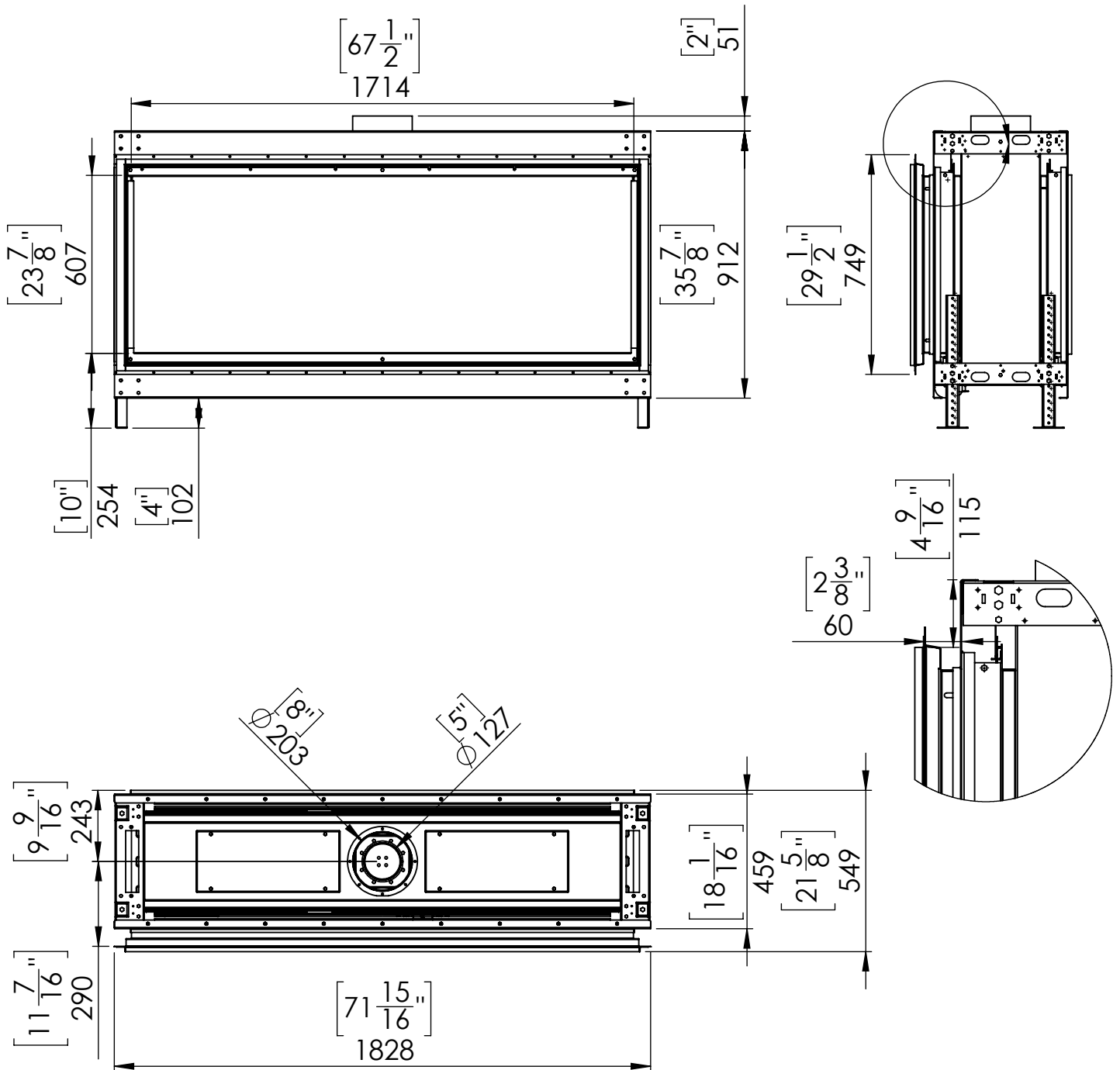

Telescopic legs ranges
(from bottom of glass): 10"-19"

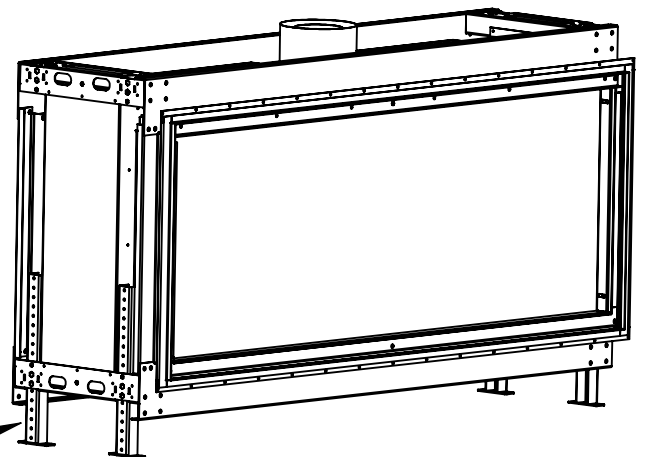

Flat installtion - option 1

Recess installtion - option 1

Metal studs **surrounding all sides** of Fireplace

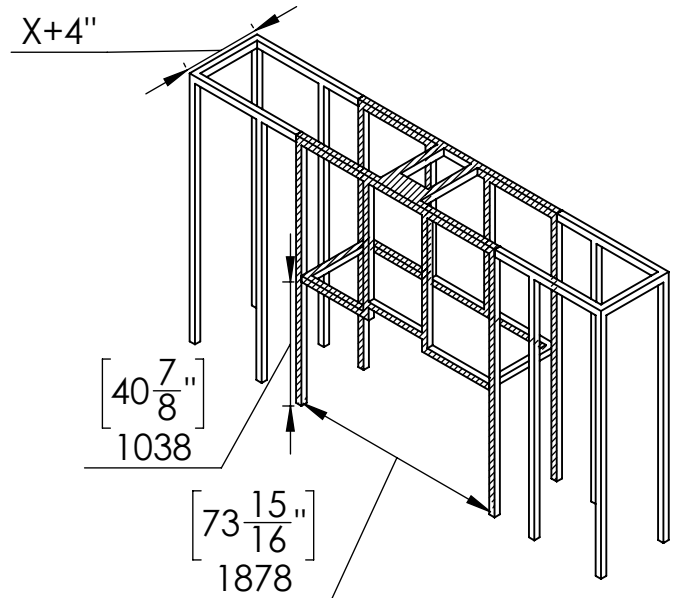
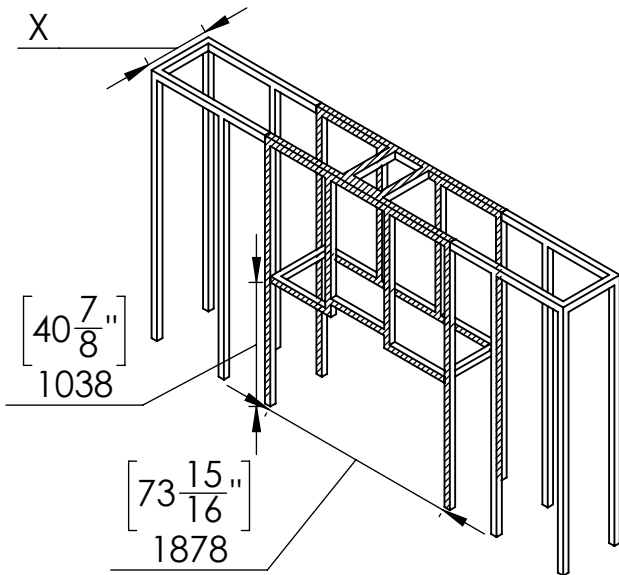

▨ Metal stud

▨ Metal stud

Flat installtion - option 2

Recess installtion - option 2

Metal studs **above** the Fireplace **only**

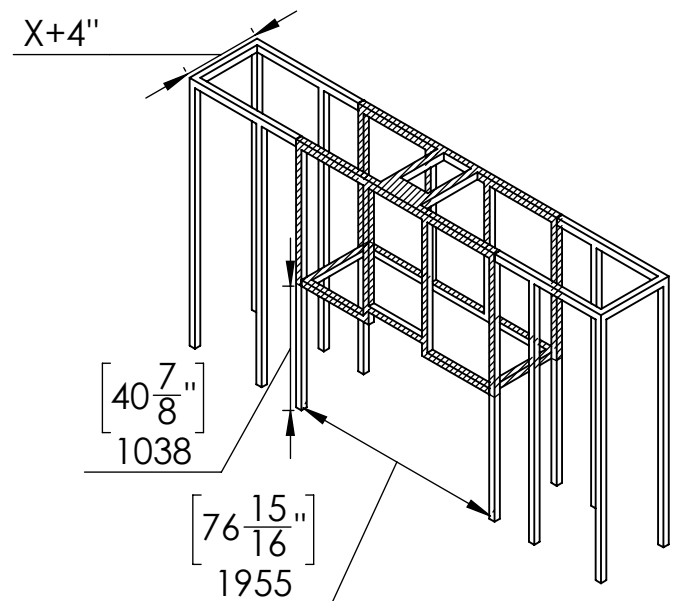
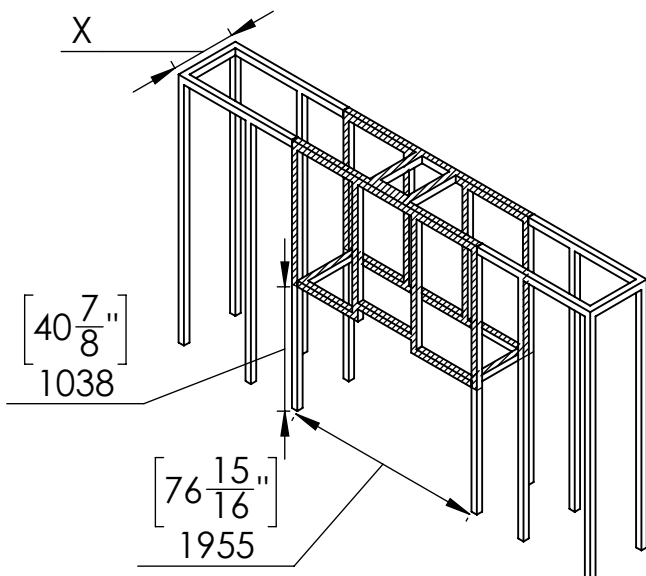

▨ Metal stud
□ Coverd Wood stud

▨ Metal stud
□ Coverd Wood stud

External Cement Board Opening

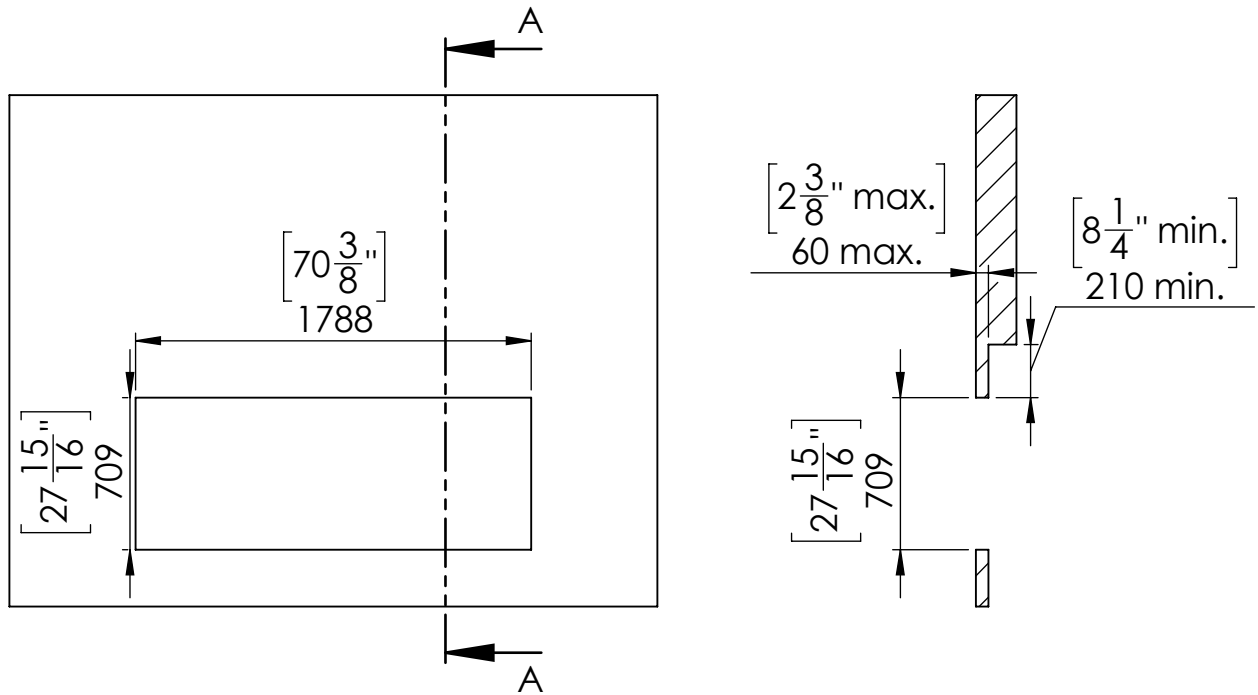

Outdoor Kit - External Frame

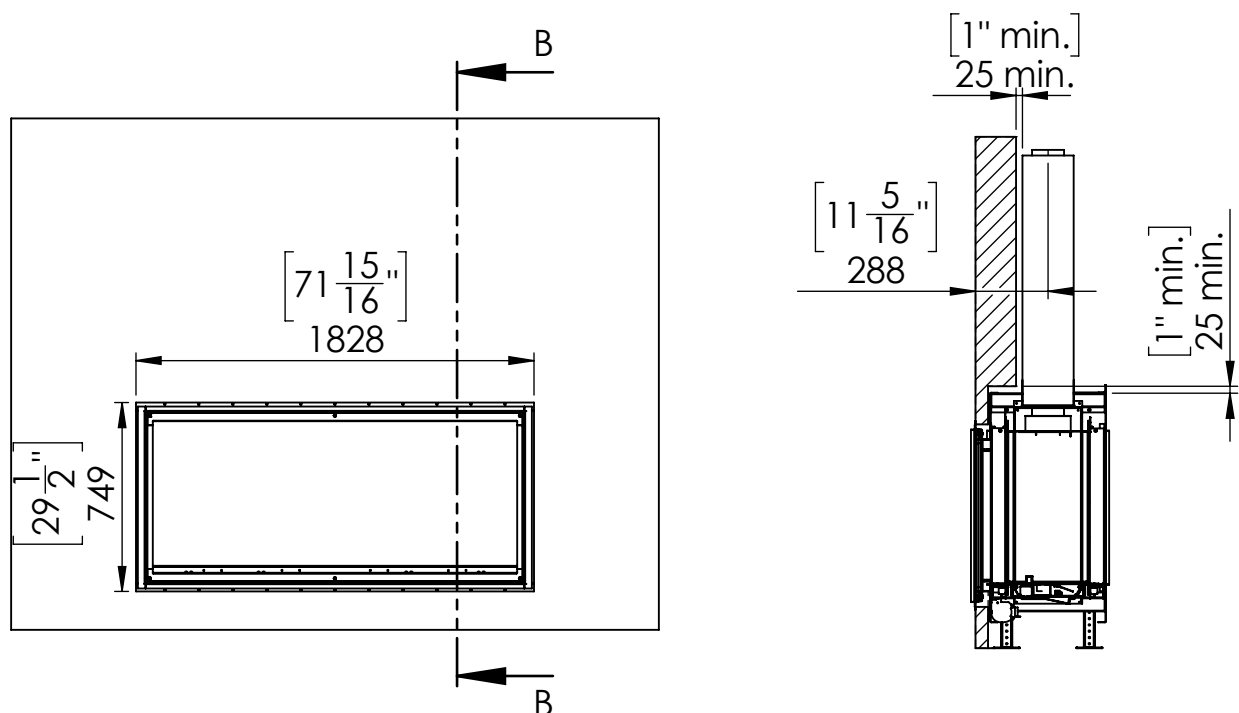

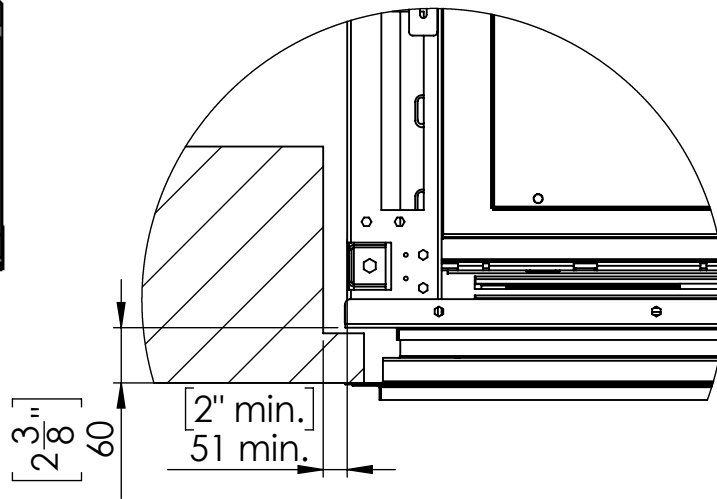
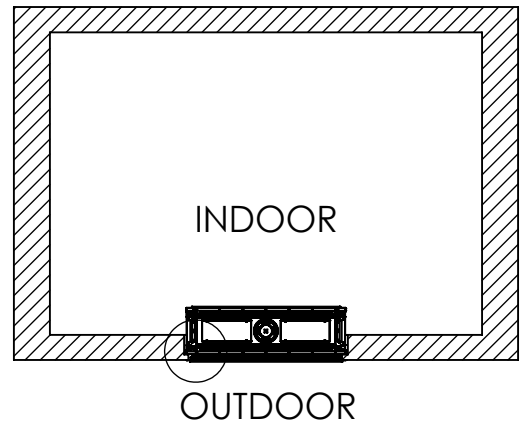
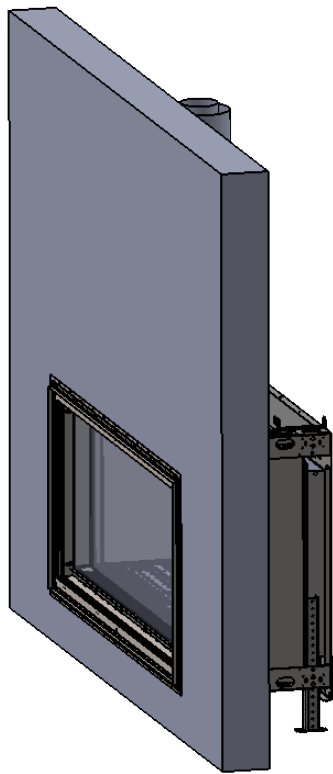

Specifications for Appliance Flare See Through 70

Factor	NG	LPG
Burner Type	35,80,35	35,80,35
Orifice	500,1000,500	160,180,160
BTU Max.	52200	43000
BTU min.	28000	20000
Kw/h	15.3k	12.6k
Chimney DIA.	5X8	5X8
Manifold Pressure[w.c]	3.6	8.8
Efficiency rate	82	79
Glass Size Length\Width	1770.5 X 620 mm	69" 11/16 X 24" 7/16'
Appliance Weigh	200Kg	440lb