

FLARE See Through 80H Outdoor

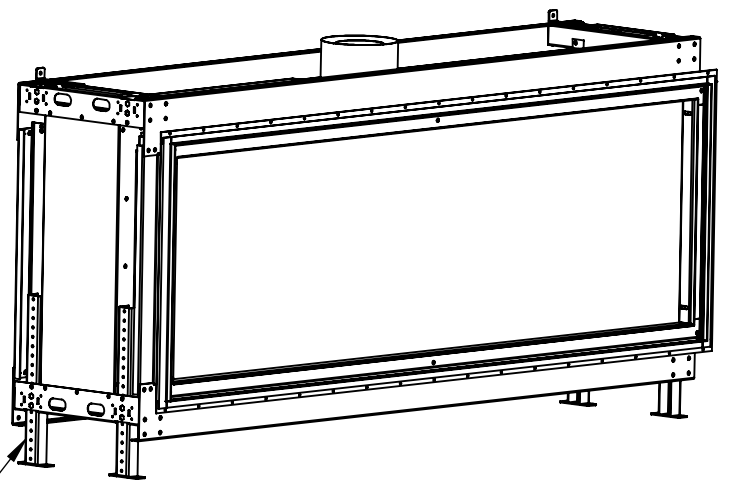
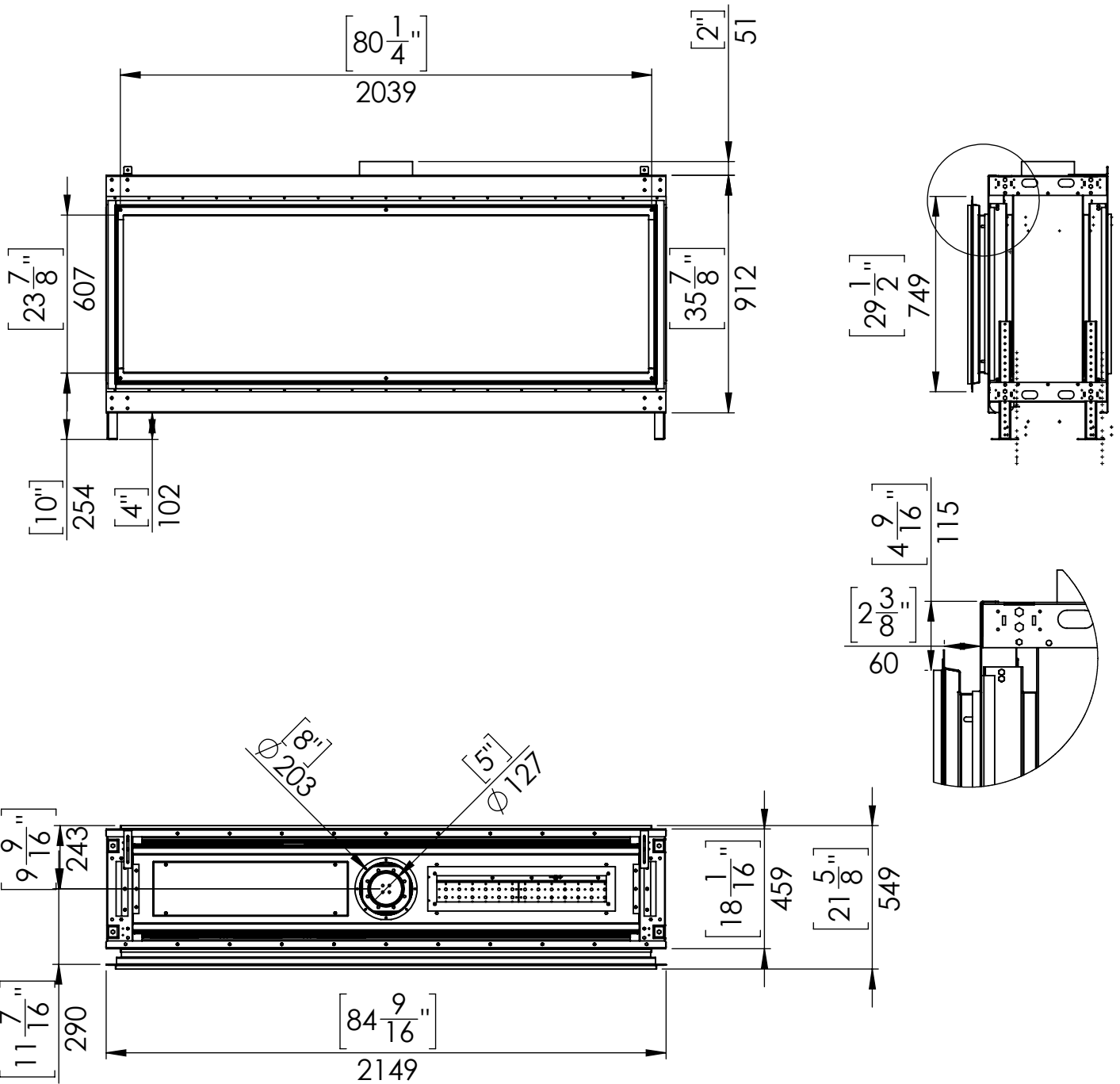

Telescopic legs ranges
(from bottom of glass): 10"-19"

Flat installtion - option 1

Recess installtion - option 1

Metal studs **surrounding all sides** of Fireplace

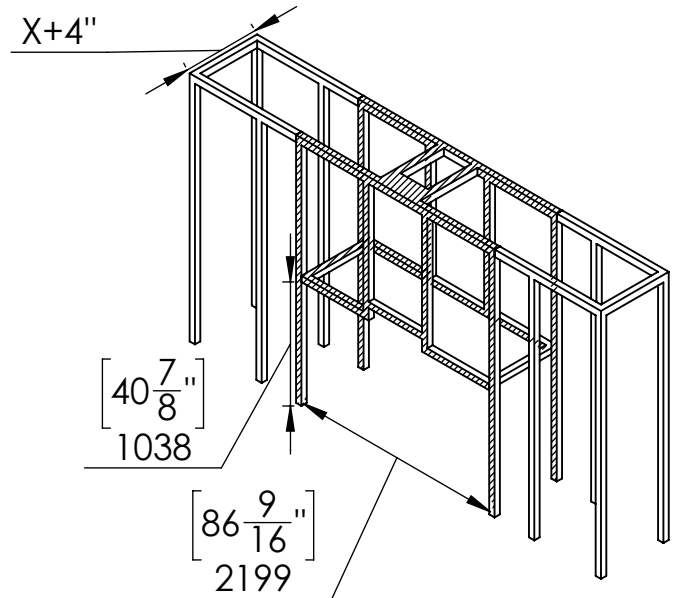
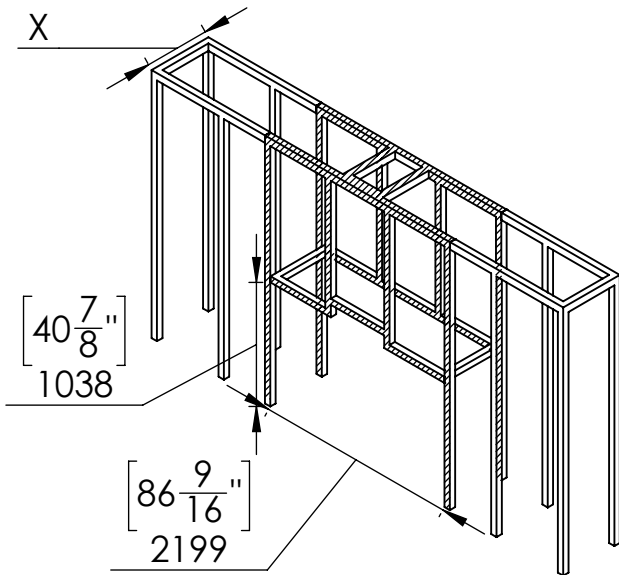

 Metal stud

 Metal stud

Flat installtion - option 2

Recess installtion - option 2

Metal studs **above** the Fireplace **only**

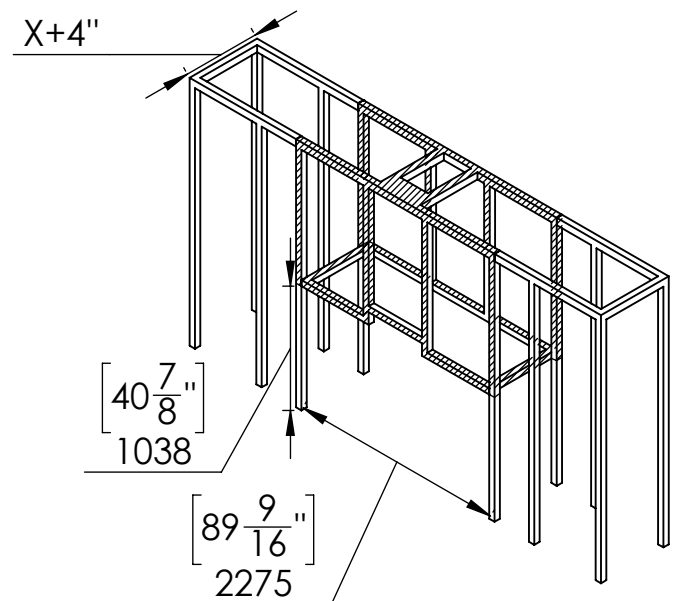
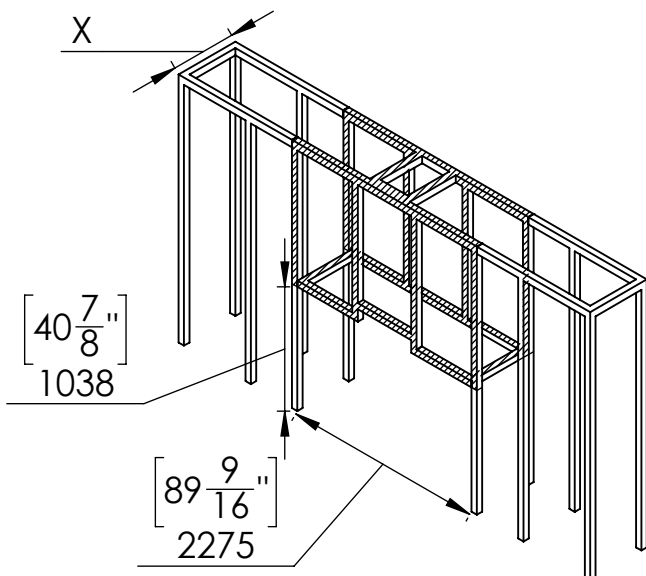

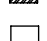
 Metal stud
 Coverd Wood stud

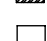
 Metal stud
 Coverd Wood stud

External Cement Board Opening

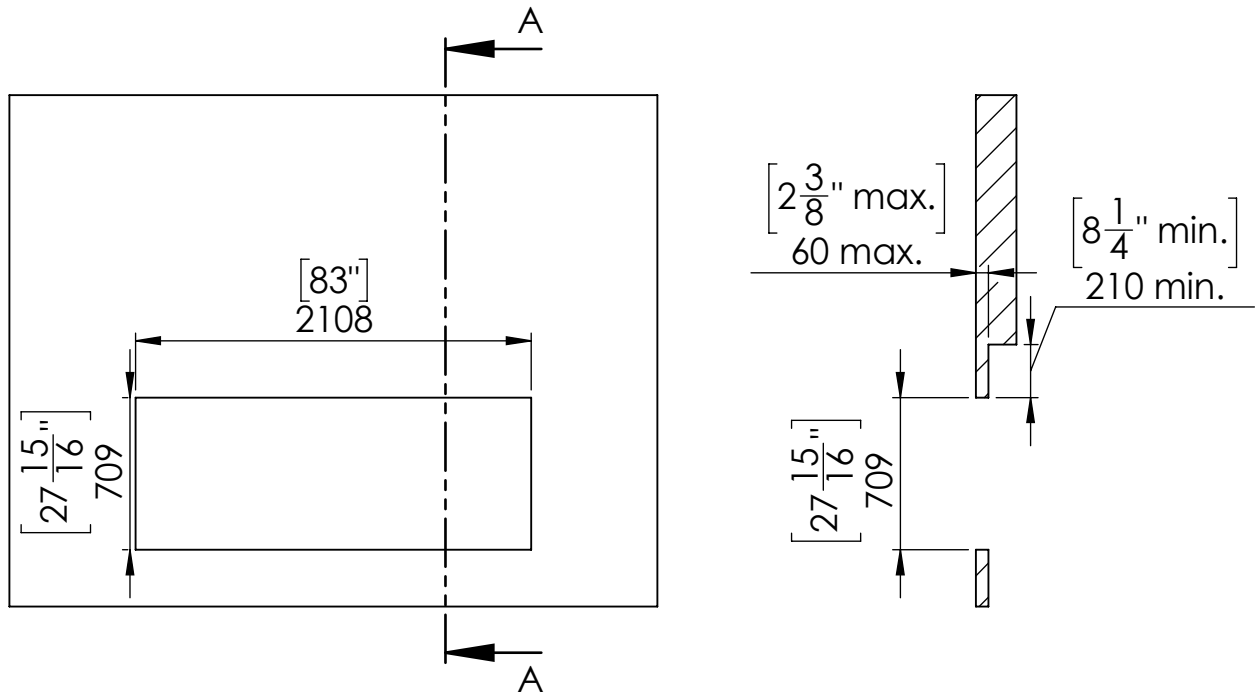

Outdoor Kit - External Frame

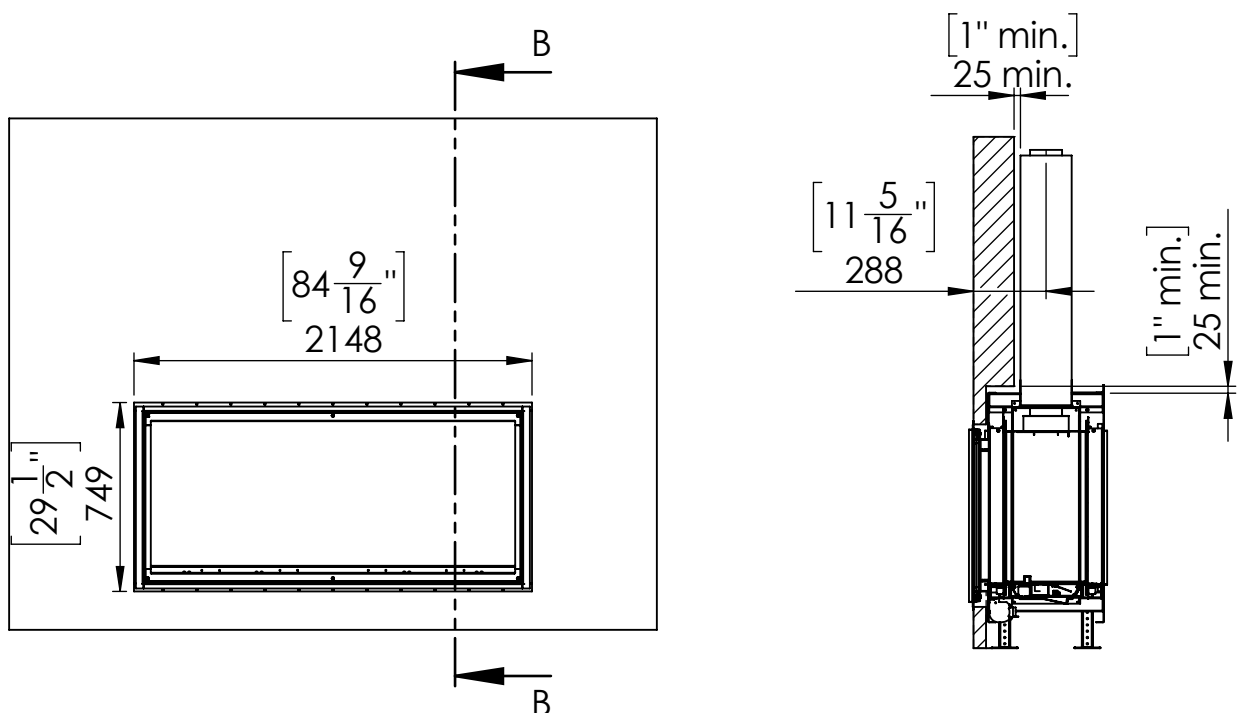

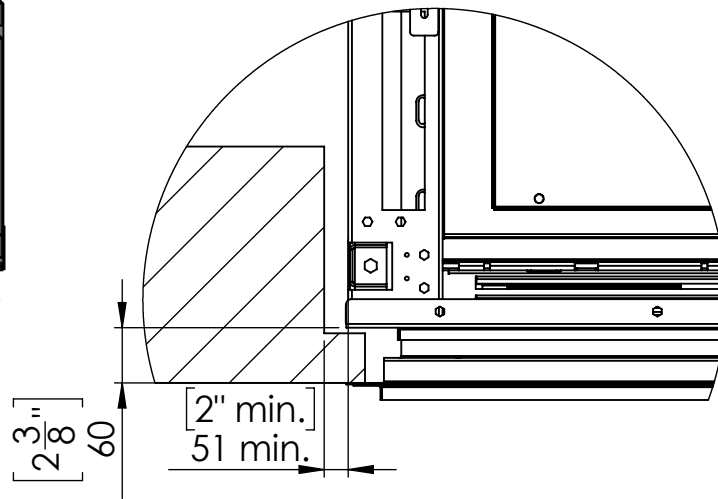
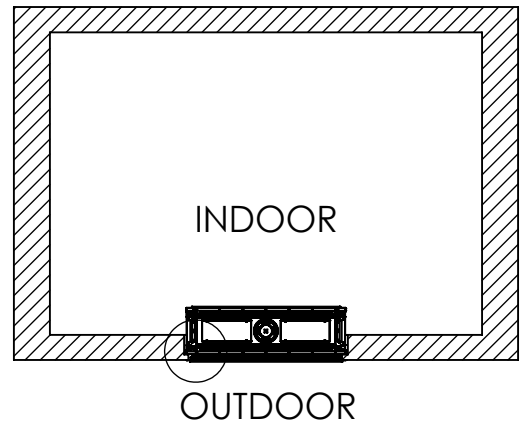
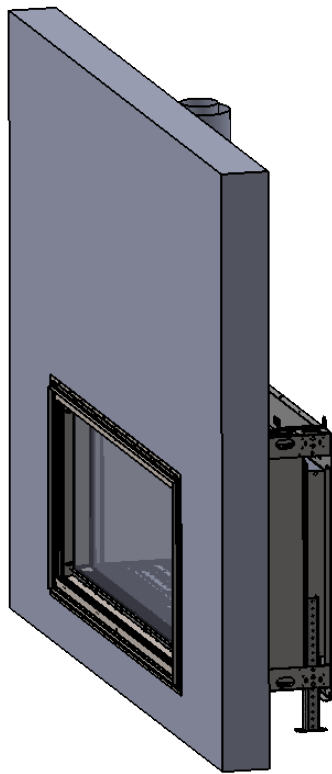

Specifications for Appliance Flare See Through 80

Factor	NG	LPG
Burner Type	35,105,35	35,105,35
Orifice	500,1200,500	160,260,160
BTU Max.	52200	43000
BTU min.	28000	20000
Kw/h	16.3k	13.5k
Chimney DIA.	5X8	5X8
Manifold Pressure[w.c]	3.4	8.8
Efficiency rate	82	80
Glass Size Length\Width	2090.5 X 620 mm	82" 5/16 X 24" 7/16'
Appliance Weigh	230Kg	507lb