



heatilator®

*The first name in fireplaces*



# Caliber Series

Direct Vent Gas Fireplace

# Caliber Series



traditional style  
**proven value**

The Caliber Series delivers bold fires and impressive heating power with multiple placement options. The Caliber comes standard with a deep firebox, black metal refractory and efficient performance. The Caliber nXt upgrades the experience with a textured fiber interior, greater heat output, a standard fan to evenly distribute the heat and the RC300 remote control. Create your unique look by pairing designer front and finish options, and define your space with traditional style, proven value and a beautiful roaring fire.

## Caliber Features

- 36" or 42" viewing area
- Choose from three fronts with two finishing options for a unique look<sup>1</sup>
- Standard black metal interior panels

## Caliber nXt Features

- 36" or 42" viewing area
- Choose from three fronts with two finishing options for a unique look<sup>1</sup>
- Upgraded fiber interior panels
- Standard RC300 remote
- Standard fan kit

## Options

### Interior Panels



Black Metal Interior Panels  
(standard on Caliber)



Traditional Interior Panels



Herringbone Interior Panels  
(Caliber nXt only)

### Fronts<sup>1</sup>



Simon<sup>2</sup>



Craftsman



Contour

### Front Finishes



Black



Bronze

### Controls



#### IntelliFire Plus RC300

Thermostat mode, timer mode, room temperature readout, two additional auxiliary functions, wall docking station, pilot activation, automatic battery backup, 5-step flame height, child lock, fan speed, on/off



#### IntelliFire Plus RC200

Pilot activation, battery strength indicator, automatic battery backup, 5-step flame height, child lock, fan speed, on/off



#### IntelliFire Plus RC100

Battery strength indicator, automatic battery backup, on/off

### Additional Options Not Pictured

- Fan Kit
- Heat-Zone™ Kit
- Gas Conversion Kits
- Mantels and Surrounds

### Venting

- Direct Vent: DVP pipe and SLP pipe

**IntelliFire™ Plus Ignition System** The IntelliFire Plus ignition system (IPI Plus) is an advanced intermittent pilot ignition system with memory settings and a programmable wireless control. IPI Plus constantly monitors ignition, ensures safe functioning and conserves up to \$10/month in energy costs. To learn more, visit [heattilator.com](http://heattilator.com).

**Direct Vent Technology** Direct Vent fireplaces remove 100% of combustion exhaust and odors outside of the home. These sealed fireplaces provide optimal heat, conserve energy and ensure clean, safe indoor air quality. To learn more, visit [heattilator.com](http://heattilator.com).

**Cover:** Caliber nXt shown with Contour front in bronze, standard traditional interior panels and custom shelf mantel

**Left:** Caliber shown with Simon front in black, black metal interior panels, Steel Gray granite surround and Roxborough mantel

1: Front is required to complete fireplace

2: Simon available in black only



# Technical Specifications

MODEL	FRONT WIDTH		BACK WIDTH		HEIGHT		DEPTH		VIEWING AREA	BTU/HR INPUT
	UNIT	FRAMING	UNIT	FRAMING	UNIT	FRAMING	UNIT	FRAMING		
CD4236IR-D, CNXT4236-D	41" (1041mm)	42" (1067mm)	28-1/2" (724mm)	42" (1067mm)	39-7/8" (1013mm)	40-1/8" (1019mm)	21" (533mm)	22" (559mm)	35" x 24-1/8" (889mm x 613mm)	16,000 - 30,000 23,000 - 40,000
CD4842IR-D, CNXT4842-D	48" (1219mm)	49" (1245mm)	35-1/2" (901mm)	49" (1245mm)	41-7/8" (1064mm)	42-1/8" (1019mm)	21" (533mm)	22" (559mm)	42" x 26-1/8" (1067mm x 664mm)	18,000 - 35,000 25,000 - 45,000

Left Side

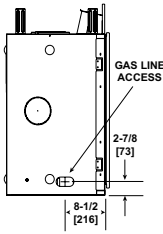

Front

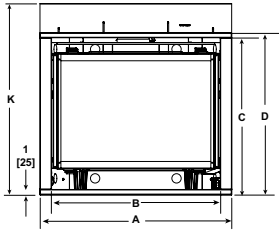

Right Side

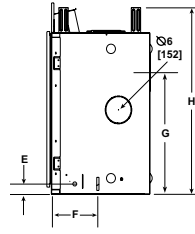

Top

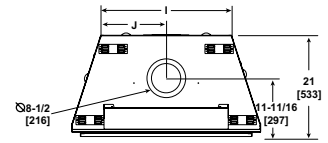

MODEL	A	B	C	D	E	F	G	H	I	J	K
CD4236IR-D, CNXT4236-D	41" (1041mm)	36-1/8" (918mm)	33-1/2" (851mm)	34-5/8" (879mm)	2-1/4" (57mm)	9-11/16" (246mm)	26-7/8" (683mm)	39-7/8" (1013mm)	28-1/2" (724mm)	14-1/4" (362mm)	40-7/8" (1038mm)
CD4842IR-D, CNXT4842-D	48" (1219mm)	43-1/8" (1096mm)	35-1/2" (902mm)	36-5/8" (930mm)	2-3/8" (60mm)	9-15/16" (252mm)	28-7/8" (734mm)	41-7/8" (1064mm)	35-1/2" (901mm)	17-3/4" (451mm)	42-7/8" (1089mm)

## Clearances

MODEL	A	B	C	D	E	F	G	H	I
CD4236IR-D, CNXT4236-D	51" (1295mm)	42" (1067mm)	72" (1829mm)	56-5/8" (1438mm)	See Inst. Manual	22" (559mm)	17-3/4" (451mm)	8" (203mm)	6-3/4" (171mm)
CD4842IR-D, CNXT4842-D	55-7/8" (1419mm)	49" (1245mm)	79" (2007mm)	61-1/2" (1562mm)	See Inst. Manual	22" (559mm)	19-3/4" (502mm)	10" (1064mm)	10-1/8" (257mm)

NOTE: THE REAR STANDOFF MAY NEED TO BE REMOVED WHEN VENTING AT 45°

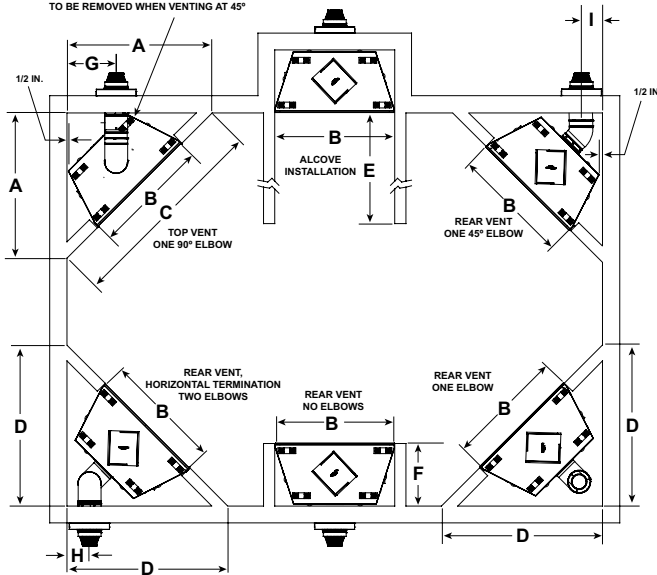

## Framing

MODEL	A ROUGH OPENING (WIDTH)	B ROUGH OPENING (HEIGHT)	C** ROUGH OPENING (DEPTH)	D ROUGH OPENING (WIDTH)	E CLEARANCE TO CEILING
CD4236IR-D, CNXT4236-D	10" (254mm)	40-1/8" (1019mm)	22" (559mm)	42" (1067mm)	25" (635mm)
CD4842IR-D, CNXT4842-D	10" (254mm)	42-1/8" (1019mm)	22" (559mm)	49" (1245mm)	25" (635mm)

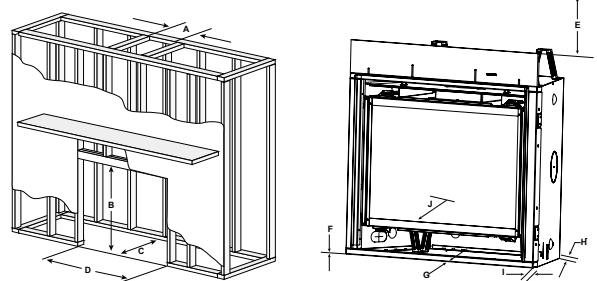

MODEL	F COMBUSTIBLE TO FLOOR	G COMBUSTIBLE FLOORING	H BEHIND APPLIANCE	I SIDES OF APPLIANCE	J FRONT OF APPLIANCE
CD4236IR-D, CNXT4236-D	0" (0mm)	0" (0mm)	1/2" (13mm)	1/2" (13mm)	36" (914mm)
CD4842IR-D, CNXT4842-D	0" (0mm)	0" (0mm)	1/2" (13mm)	1/2" (13mm)	36" (914mm)

The rough framing dimensions shown represent the distance from stud to stud only and do not take into consideration the addition of drywall. Please refer to installation instructions for complete specifications and drawings when installing this product. Go to [heatilator.com](http://heatilator.com) to download.

## EnerGuide (CSA P.4.1-15) Ratings

Used in Canada and some U.S. states to measure annual fireplace efficiency.

CD4236IR/ILR-D	CD4842IR/ILR-D	CNXT4236IT/H-D	CNXT4842IT/H-D
64% (NG) / 67% (LP)	67% (NG) / 70% (LP)	68% (NG) / 67% (LP)	68% (NG) / 71% (LP)

Available from

**heatilator**  
The first name in fireplaces

800-927-6841 | [heatilator.com](http://heatilator.com)  
[facebook.com/Heatilator](https://www.facebook.com/Heatilator)  
[twitter.com/Heatilator](https://twitter.com/Heatilator)  
[youtube.com/HeatilatorFireplaces](https://www.youtube.com/HeatilatorFireplaces)

## Limited Lifetime Warranty<sup>2</sup>

The strongest in the industry, Heatilator provides a limited lifetime warranty on gas-burning products of the most important aspects: firebox and heat exchanger.

The information provided in this literature is for planning purposes only and subject to change. Please consult the installation manual for actual installation. Actual product appearance may differ from product images.

<sup>2</sup> For full warranty details go to [heatilator.com](http://heatilator.com).

HTL-1096U-0917

