

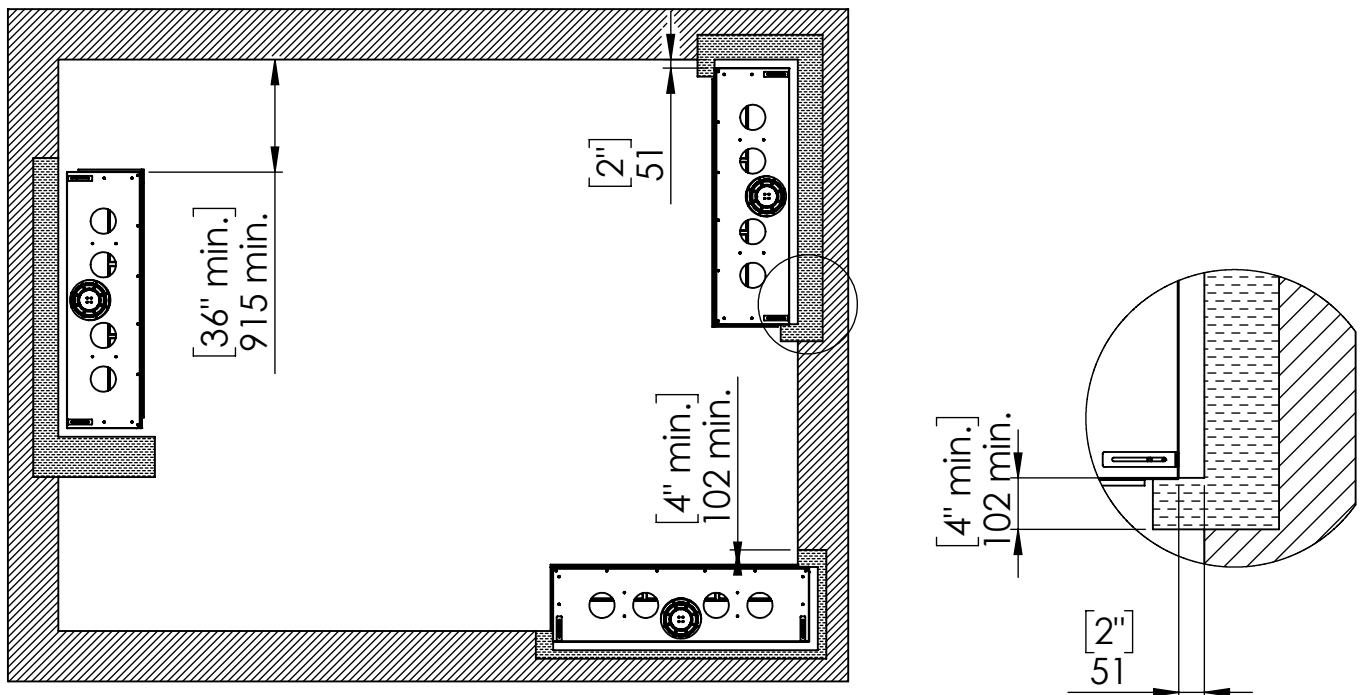

Specifications for Appliance Flare Right Corner 25

| Factor | NG | LPG |
|-------------------------|----------------|---------------------|
| Burner Type | 35 | 35 |
| Orifice | 650 | 220 |
| BTU Max. | 30000 | 20000 |
| BTU min. | 17500 | 12500 |
| Kw/h | 8.8k | 5.8k |
| Chimney DIA. | 4X6 | 4X6 |
| Manifold Pressure[w.c] | 5.4 | 8 |
| Efficiency rate | 81 | 77 |
| | | |
| Glass Size Length\Width | 570.5 X 620 mm | 22 7/16" X 24 7/16" |
| Appliance Weigh | 95kg | 210lb |

Appliance Location



 Combustible Materials
 Non Combustible Materials

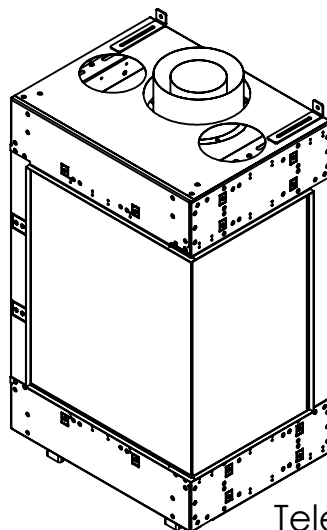
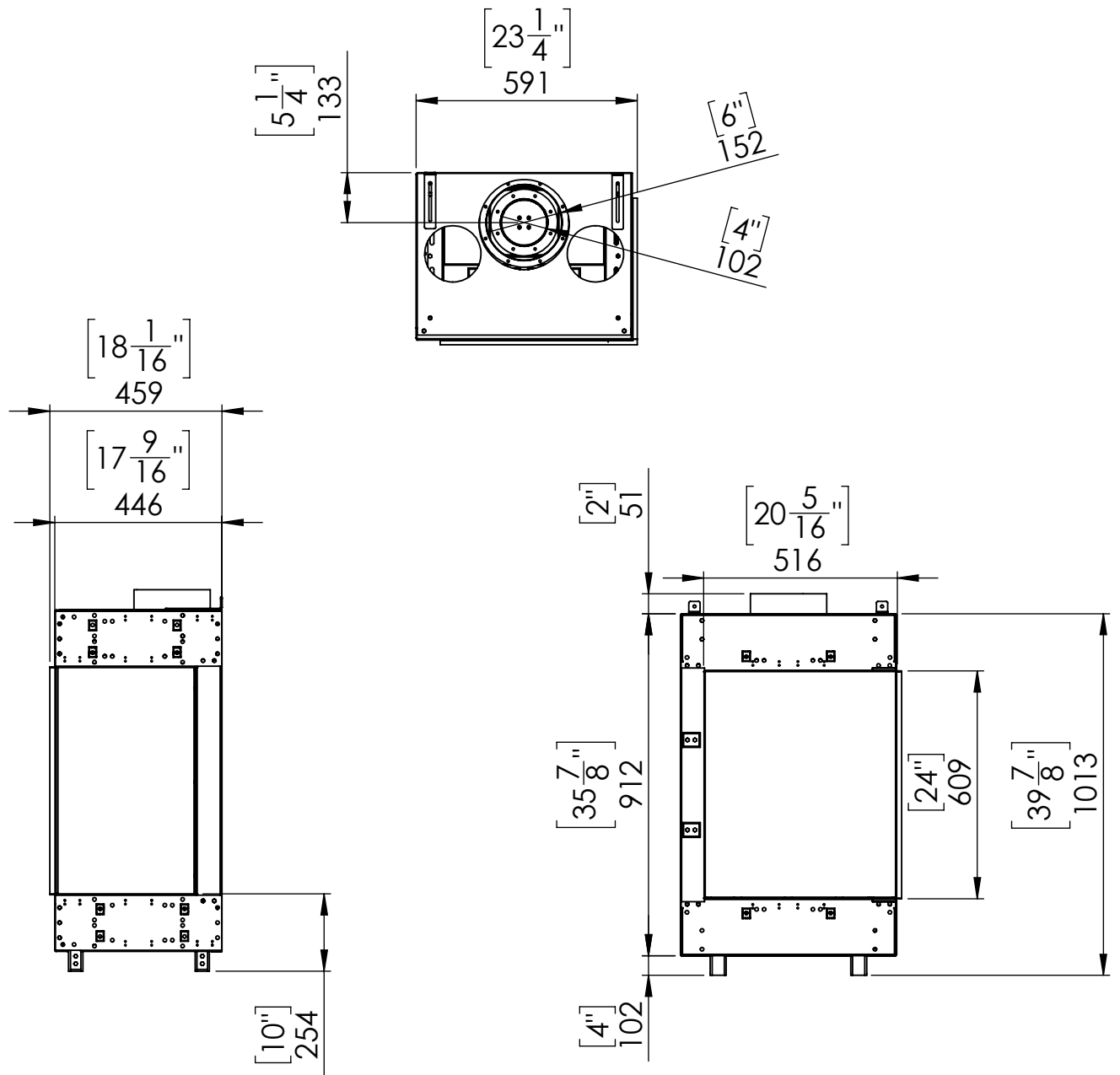

Telescopic leg ranges
(from bottom of glass): 10"-19"

Flat Installation

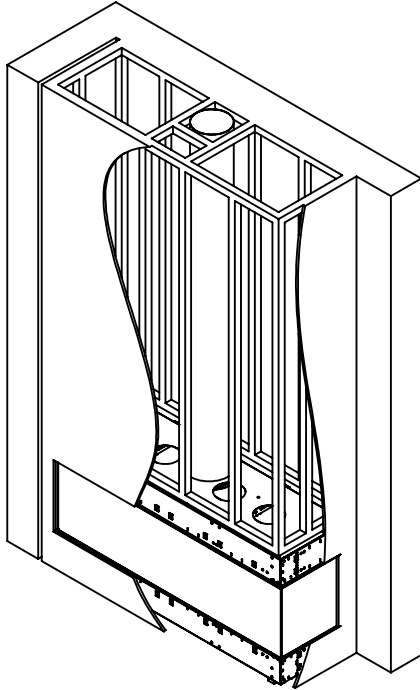

Step 1 - Basic Framing :

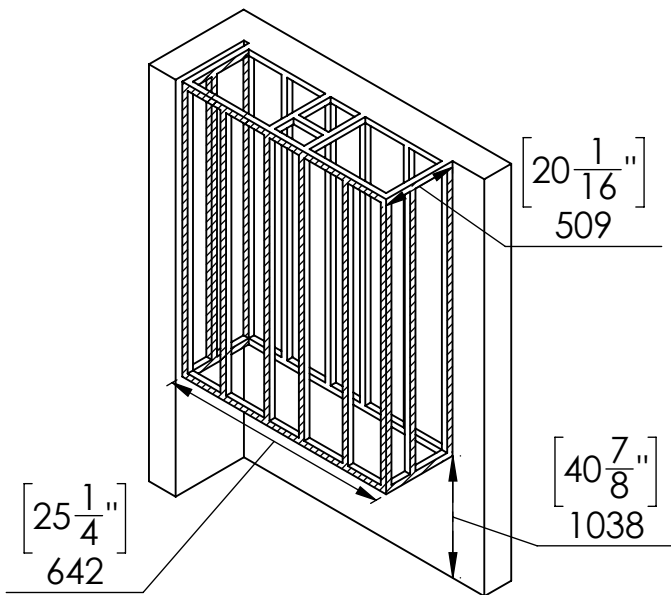

 Metal Stud

Recess Installation

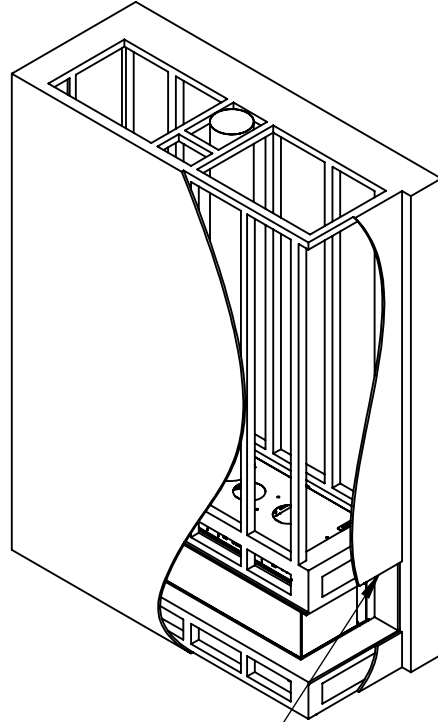

Top of Recess
4" max

Step 1 - Basic Framing :

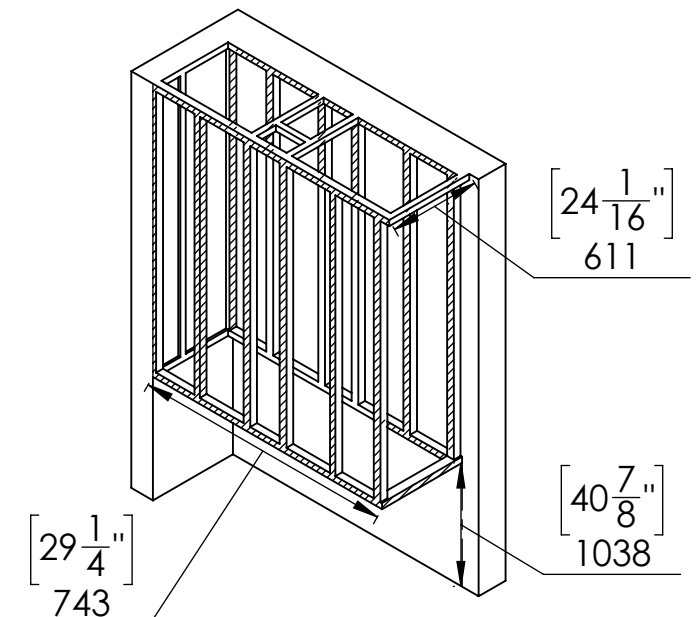

 Metal Stud

Flat Installation

Step 2 -Positioning the Fireplace:

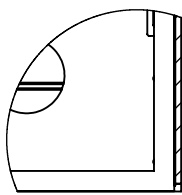
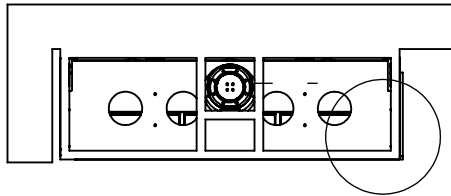

Fireplace frame finishing holder space to match wall finishing thickness

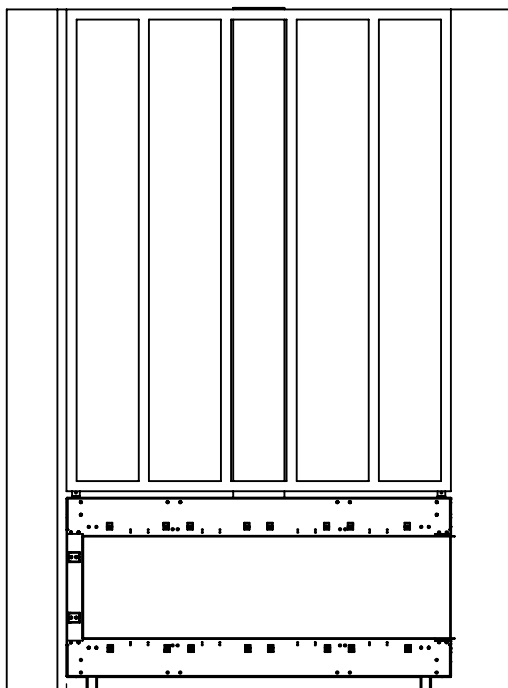

$2\frac{1}{2}$ "
63

Recess Installation

Step 2 -Positioning the Fireplace:

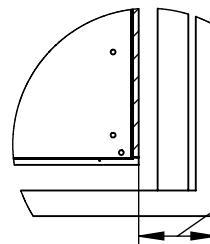
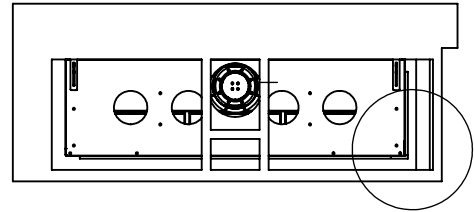

[4"] gap to match the max. length of top shelf.
102

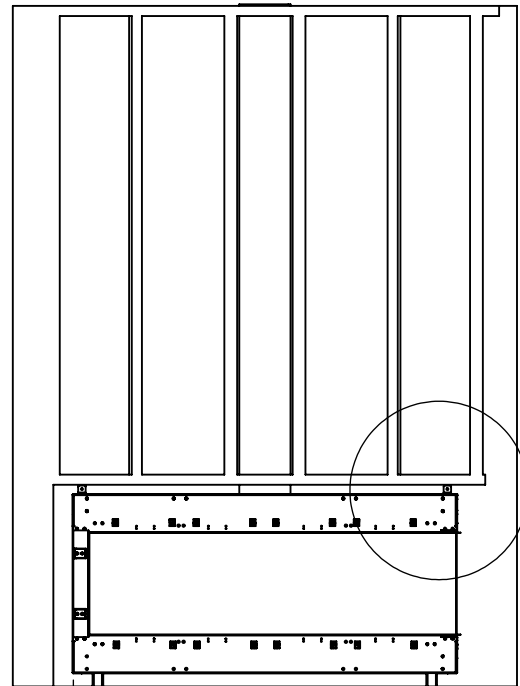

$2\frac{1}{2}$ "
63

[2"]
51

[4" max.]
102 max.

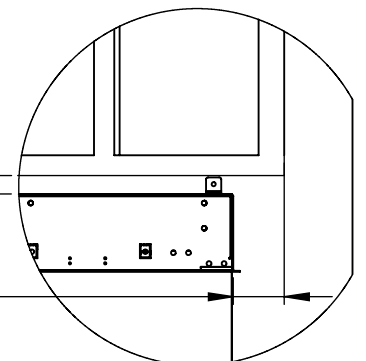

Flat Installation

Last Step - Finishing The Fireplace Wall:

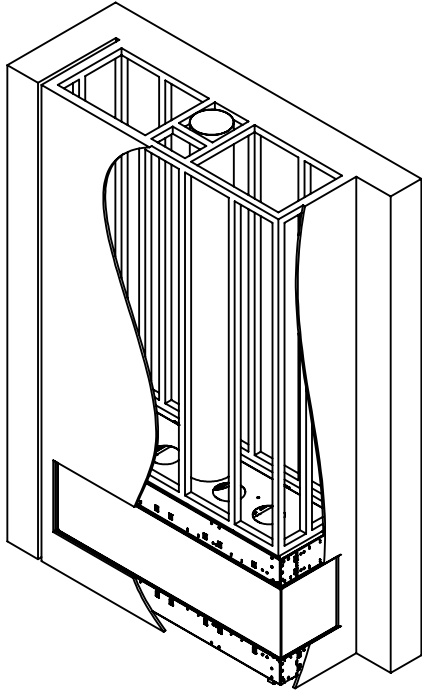

Recess Installation

Step 3 - Framing Front Studs For Recess
After positioning the Fireplace:

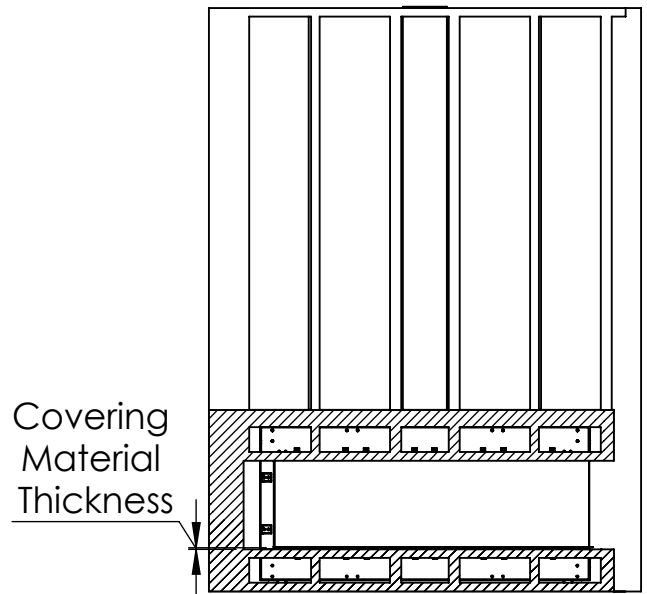

Last Step - Finishing The Fireplace Wall:

